

# Ammenities

Ground +16 Floors  
 Earthquake Resistant Rec Structure  
 Well Designed Entrance Lobby And Lift Lobbies  
 Reputed Brand Fire Fighting System  
 High End Security System  
 Ultra Modern Amenities

## Flooring

- Italian marble flooring in Living Room
- Wooden Flooring in Master Bedroom
- Vitrified Flooring in Other Bedrooms & Passage
- Anti-skid tiles for bathrooms



## Wall Finish

- External Painting - Water proof acrylic paint.
- Internal Painting - Putty/POP/Gypsum coated finished walls painted with acrylic paint.



## Kitchen

- Modular kitchen (optional with additional cost)
- Granite Platform
- Stainless steel sink.
- 2 feet tiles above platform.



## Toilet

- Designer tiles upto ceiling height.
- Good quality fittings, branded washbasin,
- Loft above one toilet.

## Doors & Windows

- Door shutters - Decorative main door with laminate.
- Window shutters - Powder coated aluminium sliding windows

## Electrification

- Concealed ISI quality wiring.
- Telephone Cable TV and AC point with concealed electrical fittings.
- Branded modular switches

## Security

- Intercom facility from ground floor lobby to each lift and intercommunication facilities

## Plumbing

- Concealed Piping system in kitchen and toilet.

## Lift & Power backup

- Branded lift.
- Inverter/Generator: back up for lift and common area.



## Location Map

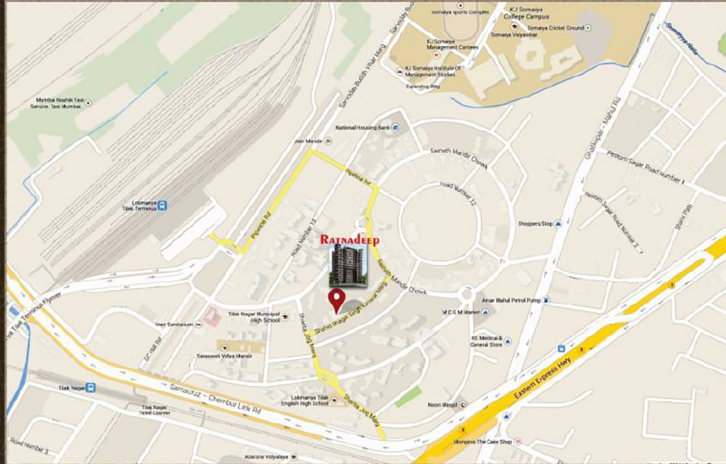

- Nearby Lokmarya Tilak Terminus
- Close to reputed Schools, Colleges, Luxury Hotels,
- Near to Place of Worship, Hospital and Market



**Project Consultants**  
 Elora Project Consultant Pvt. Ltd.

**Contractor**  
 Build Musallas

**Project Associates**  
 Gagangri Construction

MaharERA No: P51900005835

**Contact Number**  
 9699 957 957

**Email / Website**  
[enquiry@buildtechgroup.co.in](mailto:enquiry@buildtechgroup.co.in) / [www.buildtechgroup.co.in](http://www.buildtechgroup.co.in)

**Developers**  
 Wastin Developers

**Office**  
 A-407, Samartha Aishwarya, Opp Tarapore Tower, Lokhandwala  
 Andheri (W), Mumbai – 400 053

Disclaimer – The information contained in this document does not constitute an offer or a contract and is subject to the approval of concerned authorities or in the interest of the continuing improvement, the promoters / developers reserve exclusive rights to change plans, specifications or features without prior notice or obligation of any nature.



# RATNADEEP

125, Shahid BHAQAT SINGHI KANWAR MARG, TILAK NAGAR, KURLA EAST MUMBAI, MAHARASHTRA 400089



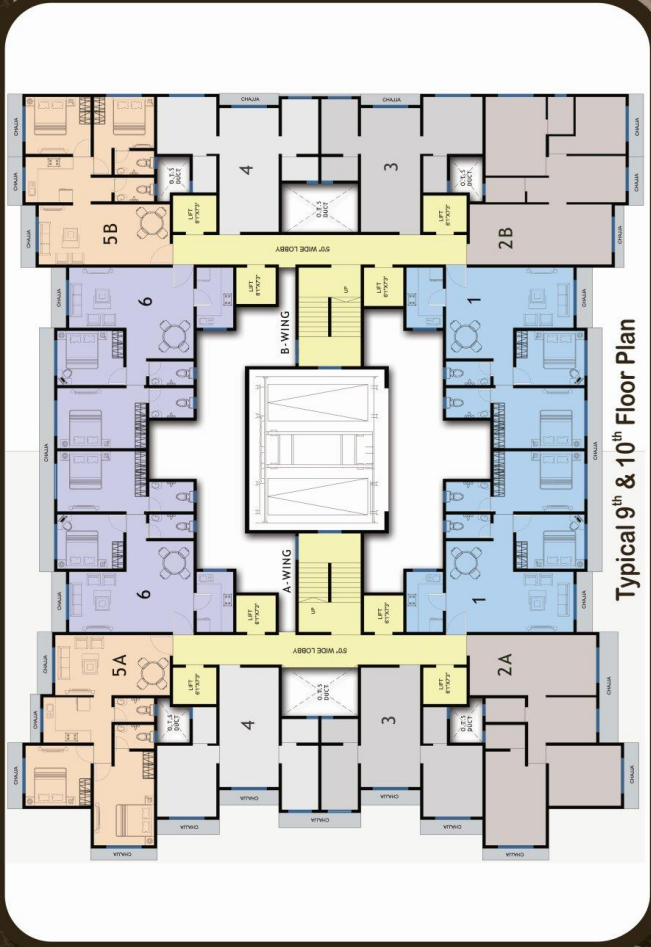

Typical 9<sup>th</sup> & 10<sup>th</sup> Floor Plan

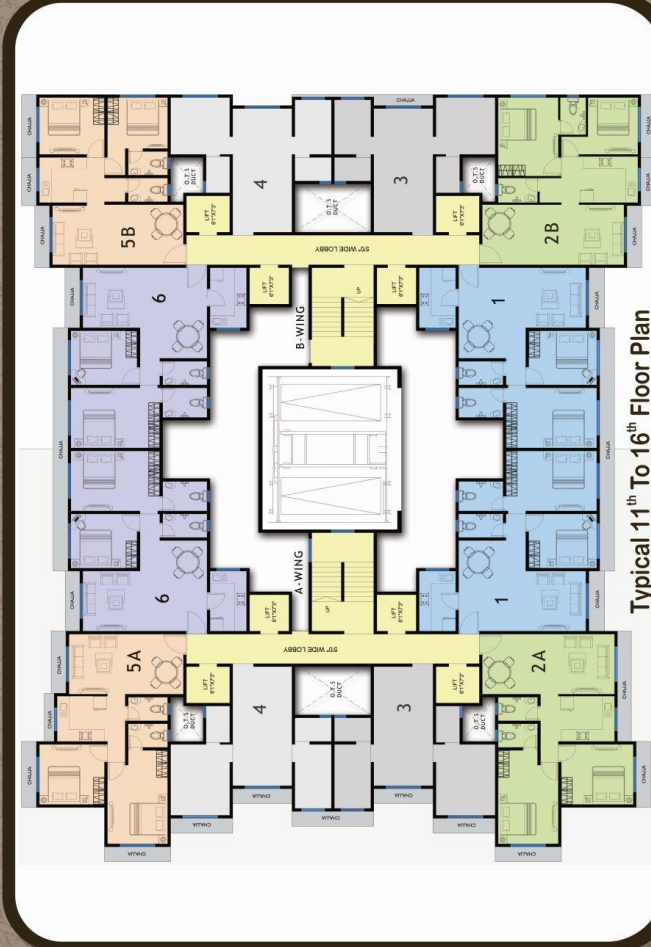

Typical 11<sup>th</sup> To 16<sup>th</sup> Floor Plan